

**EPIC**  
FUTUREPROOF

# POPSCAN

Fingerprint Digital Door Lock

# User Manual



Dead Bolt / Hook Type



A/S Hotline : +82-70-7124-6911 Website : [www.epic.co.kr](http://www.epic.co.kr)

This product should be installed by skilled installer.  
Faulty installation by end-user can result to product defect  
And can be void for claim of product warranty.

# FEATURES



## Defect Free, Strong Sturdy Door Lock

With KC & KS Quality Certification



## Strong & Durable Body Components

Made To Withstand Heat And Electrical Shocks



## Automatic Lock / Relock / Dual Lock Features

Designed To Fit Consumer's Security Needs Conveniently



## Password-hide feature

Imaginary number feature conceals the original pin number from being exposed



## Pin Number & Fingerprint Registration Feature

You Can Register Pin Number  
And Fingerprint (Up To 100 Sets) Easily.



## Dual-mode Security Feature

When the Dual-mode security is set after the user password has been registered  
2nd authentication is needed and the door will open.



## Adjustable Volume Setting With Muting Features

Sound Can Be Adjusted In 7 Steps easily.



## Easy To Use Even At Night

White Light Number Pad Feature



## External 9V Emergency Battery Terminal

Initialize the lock when the battery is discharged



## Anti-Shock /Anti-Fire / Anti-Hacking Emergency Alarm System

Generates an alarm when senses high temperature inside, and automatically unlock.

# USER SAFETY

- ❗ Please do not repair the product by your self.



- ❗ Please check environment before installation.



- ❗ Read the manual carefully.

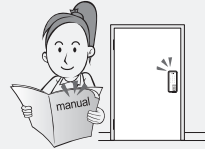

- ❗ Please do not use any object to operate the lock.



- ❗ Please change your pin number periodically.

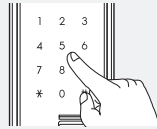

- ❗ Please do not knock or apply force on the lock.



- ❗ Place only new batteries.



- ❗ Protect the product from wetness or moisture.

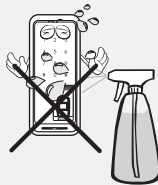

- ❗ Replace only with new batteries.

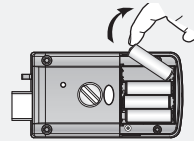

- ❗ Clean the lock and fingerprint scanner using clean dry cloth. Do not touch with wet hands.



- ❗ Please contact your dealer or seller in-case of defect.

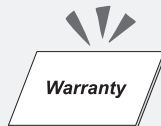

- ❗ Please use the product correspondingly.



# Contents

01	Product Dimension & Components	05
02	Parts Description (Outbody / Inbody)	06
03	User's Guide	
	1 Pin number Registration	08
	2 Fingerprint Registration	09
	3 Fingerprint Deletion	11
	4 Guest Pin number Registration	12
	5 Opening Door Outside	13
	6 Closing Door Outside	14
	7 Opening Door Inside	15
	8 Closing Door Inside	15
	9 Force Lock Setting	16
04	Convenient Features	
	1 Mute Setting	17
	2 Volume Setting	17
	3 Auto / Manual Lock Setting	18
	4 Multi-touch Feature Setting	19
	5 Dual-mode Security Feature Setting	20
05	Alarm Features	
	1 Fire Alarm	21
	2 Anti-Hacking Alarm	21
	3 Anti-prank & 1 min. lock	22
	4 Deadbolt Error Alarm	22
	5 Replace Battery Alarm	23
06	Troubleshooting	24
07	Consumer Protection Policy	24
08	Product Warranty	25

## ■ Dimension

Item		Specifications
Installation	Door Thickness	Door Thickness 35mm ~ 50mm
Authentication	Pin Number	4~12 Digits
	Fingerprint Registration	100 Fingerprints can be registered
Voltage	DC 6V	LR6 1.5V AA Size 4 Alkaline batteries
Emergency Battery	DC 9V	Alkaline batteries (Sold Separately)
Product Type	non-fireproof, Temp. Sensor, non-mech. key, Rim lock type	
Temp. Sensor	Heat Sensor Type	72°C ± 5°C (Testing Room)
		62°C ± 5°C (Normal Environment)
Material	Outbody	Al, Zn, Pc
	Inbody	Al, Zn, ABS

## ■ Components



Outbody

### HOOK

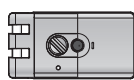

Inbody



Strike

### DEAD BOLT

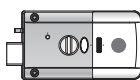

Inbody



Strike



Screw

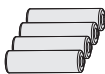

Battery 4EA

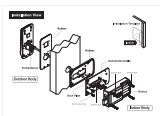

Trace Form (Dead Bolt)

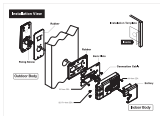

Trace Form (Hook)



User Manual

## 02 Parts Description

### ■ Outbody Part



No	Name	Description
①	Battery Lamp	Low battery status notification
②	Reset Switch	Initialize the product to normal state,when the product is operating abnormally
③	Number Pad	Enter the pin number on the number pad and the door will unlock.
④	Status LED Lamp	Green-colored LED Status lamp that lights on during F/P registration or authentication
⑤	Function Sensor Bar	This is touched to open the fingerprint sensor
⑥	Fingerprint Reader	Where the fingerprint is registered or authenticated To open the door
⑦	Emergency Battery Terminal	Re-initialize the lock by placing a 9V battery on the 9V battery terminal.

## 02 Parts Description

### ■ Intbody Part

#### HOOK

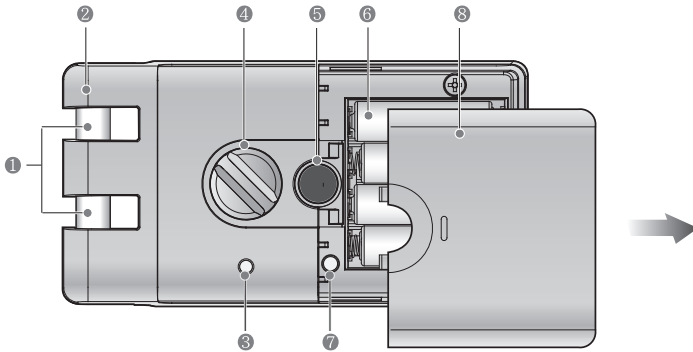

#### DEADBOLT

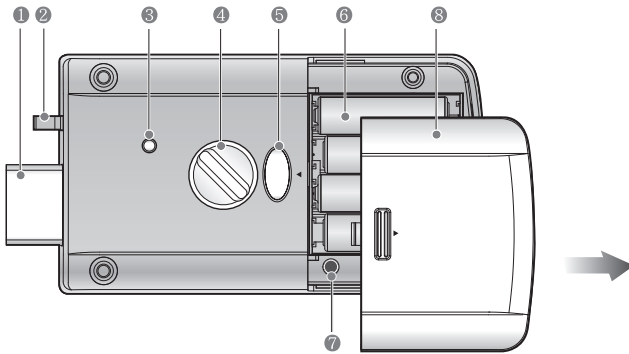

① Deadbolt	③ Safety Button	⑤ Open / Close Button	⑦ Registration Button
② Door Closing Sensor	④ Manual Lock Knob	⑥ Alkaline AA Battery	⑧ Battery Cover



#### NOTE

The manual inbody basic image is applied to Deadbolt type model.

## 03 User's Guide

### 1 Pin Number Registration

#### ⚠ Caution

Please perform registration while door is open.  
Upon purchase, Default pin number registered is 1,2,3,4



#### ※ To change existing pin number

- ① Open the [Battery Cover]  
Press [Registration] button once  
the 'beep' sound will be heard.

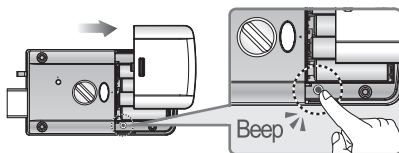

----- OUTSIDE -----

- ② Enter current pin number  
followed by [\*] button.



----- OUTSIDE -----

- ③ Check if the numbers 1, 2, 3, 9  
has been lighted on the number pad.  
Press number 1 button

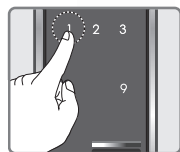

----- OUTSIDE -----

- ④ Enter new pin number to be registered. Press [\*] button.  
And the new pin number has been registered.  
When the melody is heard, the registration is complete.



#### 📄 Note

Only 1set of Pin Number can be registered

#### ⚠ Caution

After pressing Registration button, Pin Number should be entered within  
10 seconds or the registration will be cancelled.  
New registration (steps ①, ②, ③, ④) will delete all previously registered pin  
on the lock.

## 03 User's Guide

### 2 Fingerprint Registration (Normal)

#### ⚠ Caution

New registration will not delete previously registered pin number on the lock. Fingerprint deletion can be done all-at-once. Please register new one After deletion. Please refer to page 12 for fingerprint deletion. When 100 Fingerprints has been registered, You cannot register new one. insted, delete all fingerprints and register a new one.

- ① Open battery compartment cover  
Press [Registration] button once  
~beep sound will be heard

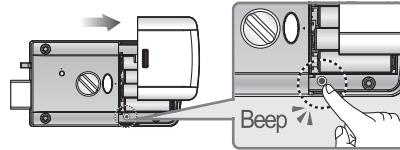

----- OUTSIDE -----

※ If Pin Number is lost fingerprint cannot be registered

- ② Enter pin number, followed by [ \* ] button.  
Check if the numbers [ 1, 2, 3, 9 ]  
is lighted on the number pad  
Press [2] button before the number pad turns off

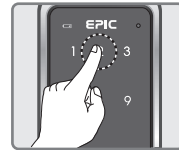

----- OUTSIDE -----

- ③ Place a finger to register three times on the fingerprint reader.  
If the first reading is successful  
numbers [1][2][3] will be displayed with blinking number [2]  
If the second reading is successful  
numbers [1][2][3] will be displayed with blinking number [3]  
Go ahead with the third reading  
Fingerprint registration is complete when the third reading is successful.  
Now you will see the location number stored for the specific fingerprint  
with an animated circle and complete sound beep.



----- INSIDE -----

- ④ Press [Registration] button after all fingerprints has  
been registered. And registration is complete.

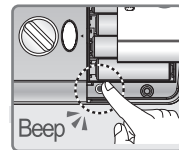

#### 📄 Note

Up to 100 fingerprints can be registered. To register multiple Fingerprints.  
Repeat steps ③ before the number pad turns off.  
And press [ Registration ] button.

#### ⚠ Caution

Please register fingerprint within 20 seconds after pressing [Registration] button  
or the registration will be cancelled.  
Corrupted or Child fingerprints may have difficulty in authentication.  
If two registered fingerprints are not matched, the fingerprint will not be registered.

## 03 User's Guide

### 2 Fingerprint Registration (Individual)

- ① Open battery compartment cover  
Press [Registration] button once  
~beep sound will be heard  
Enter pin number, followed by [ \* ] button.

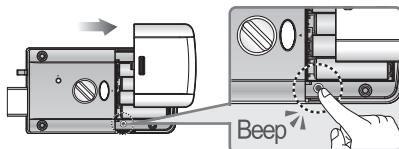

----- OUTSIDE -----

- ② Check if the numbers [ 1, 2, 3, 9 ]  
is lighted on the number pad  
Press [2] button before the number pad turns off



----- OUTSIDE -----

- ③ Enter the 3-digit fingerprint location number  
(001-100) followed by [ # ] button.  
Place a finger to register three times on the fingerprint reader  
If the first reading is successful  
numbers [1] [2] [3] will be displayed with blinking number [2]  
If the second reading is successful  
numbers [1] [2] [3] will be displayed with blinking number [3]  
Go ahead with the third reading  
Fingerprint registration is complete when the third  
reading is successful.  
Now you will see the location number stored for the  
specific fingerprint with an animated circle and complete sound beep.



----- INSIDE -----

- ④ Press [Registration] button after all fingerprints has  
been registered. And registration is complete.

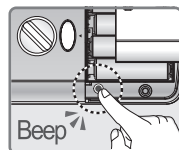

#### ⚠ Caution

The fingerprint location number should be from 001~100  
and it must consist of 3 digits always  
Without entering fingerprint, pressing [ # ] button  
will change to Normal Fingerprint registration mode.

#### 📄 Note

Up to 100 fingerprints can be registered. To register multiple Fingerprints.  
Repeat steps ③ before the number pad turns off.  
And press [ Registration ] button.

## 03 User's Guide

### 3 Fingerprint Deletion (All-at-once)

- ① Open battery compartment cover  
Press [ Registration ] button once  
~beep sound will be heard.

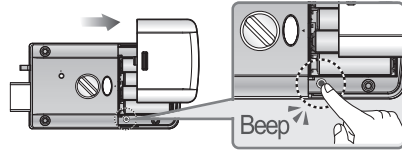

----- OUTSIDE -----

- ② Enter pin number, followed by [ \* ] button.  
Check if the number [ 1, 2, 3, 9 ]  
is lighted on the number pad  
Press [ 9 ] button.



----- OUTSIDE -----

- ③ Press [ # ] button for 5 seconds.  
A confirmation melody will be heard  
And all Fingerprints are deleted.

5 Seconds

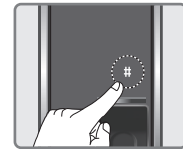

### 3 Fingerprint Deletion (Individual)

- ① Open battery compartment cover  
Press [ Registration ] button once  
~beep sound will be heard.

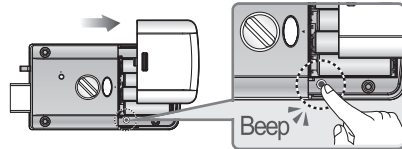

----- OUTSIDE -----

- ② Enter pin number, followed by [ \* ] button.  
Check if the number [ 1, 2, 3, 9 ]  
is lighted on the number pad  
Press [ 9 ] button.



----- OUTSIDE -----

- ③ Press [ \* ] button and the number pad numbers  
will all be lighted ON  
Enter the fingerprint Location Number, followed by [ # ] button,  
when the deletion is complete, the complete sound will be heard.  
After deletion is complete, the number pad numbers will all be lighted ON  
And additional Fingerprint Deletion is in Standby Status.



## 03 User's Guide

### 4 Guest Pin Number Registration

- ① Open battery compartment cover  
Press [Registration] button once  
~beep sound will be heard.

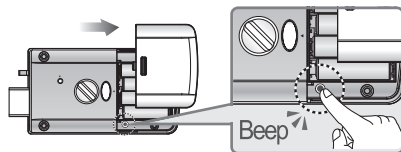

----- OUTSIDE -----

- ② Enter current pin number  
followed by [\*] button

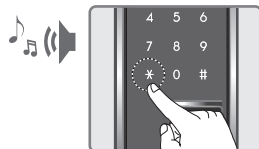

----- OUTSIDE -----

- ③ Check if the number [ 1, 2, 3, 9 ]  
is lighted on the number pad  
Press [ 3 ] button.



----- OUTSIDE -----

- ④ Enter New Guest Pin number to be registered 4~12 digits  
Press [\*] button on the number pad  
A melody will be heard, and the registration  
is complete.

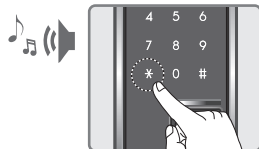

- ◆ WHEN REGISTRATION MODE IS CANCELLED OLD PIN WILL BE RESTORED
- ◆ REGISTERING MORE THAN 12 DIGITS WILL RESULT TO ERROR NO. [2] BUTTON WILL BE FLASHING
- ◆ REGISTERING LESS THAN 4 DIGITS WILL RESULT TO ERROR NO. [2] BUTTON WILL BE FLASHING
- ◆ NEW REGISTRATION WILL DELETE OLD REGISTERED PIN NUMBER
- ◆ IF NEW PIN NUMBER IS NOT REGISTERED AFTER PRESSING REGISTRATION BUTTON  
THE REGISTRATION MODE WILL BE CANCELLED
- ◆ THE GUEST PASSWORD IS FOR 1 TIME ENTRY ONLY

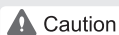

Caution

THE GUEST PASSWORD IS FOR 1 TIME ENTRY ONLY

## 03 User's Guide

### 5 Opening from Outside

#### METHOD 1 Fingerprint



Press the function sensor bar



Place your registered finger on the Fingerprint reader



A melody will be heard  
And the door will open



#### Note

5 failed pin registration will activate 5 minute lock

### 5 Opening from Outside

#### METHOD 2 Pin Number

- ① Touch the [Number Pad],  
Enter the [Pin Number]

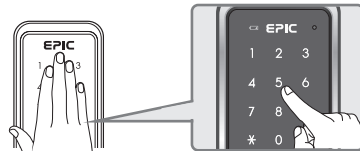



- ② Press [ ] button, a melody will be heard  
and the door will open.



## 03 User's Guide

### 5 Opening from Outside

#### Random Number Feature

Touch the number pad, enter any random number, Enter pin number, press [  ] button  
Or Enter pin number first, then enter any random number, Then press [  ] button  
And the door will open



#### Note

This is a security feature that keeps the pin number from being exposed by the additional Random number that is added before or after the original pin number  
The number to be entered including the pin number should not exceed 20 digits.



#### Caution

When multi-touch security feature is enabled  
After entering pin number, 3 random number will be lighted on the screen.  
Press this 3 number followed by [  ] button. And the door will open.  
During multi-touch security setting, the random number feature is disabled  
The multi-touch security feature is disabled in default.

### 6 Closing Door Outside

#### METHOD 1

#### Automatic Mode

- ▶ The door will automatically lock  
Within 2 seconds of closing the door (18 Page)

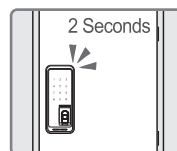

#### METHOD 2

#### Manual Mode

- ▶ Touch the [Number Pad],  
to close the door. (18 Page)



## 03 User's Guide

### 7 Opening Door Inside

#### Note

Open the door within 7 seconds, or it will automatically re-lock.



#### METHOD 1 Open / Close Button

- ▶ Press the [Open / Close] button on the inbody, and the door will open.

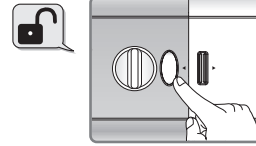

#### METHOD 2 Manual Mode

- ▶ Turning the [Manual] knob to [Open] direction, and the door will open.

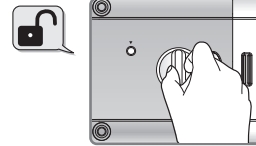

### 8 Closing Door Inside

#### METHOD 1 Automatic Mode

- ▶ Closing the door, the door will automatically lock after about 7 seconds.

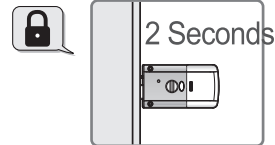

#### METHOD 2 Open / Close Button

- ▶ Press the [Open / Close] button on the inbody, and the door will open.

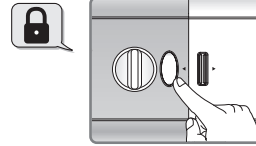

#### METHOD 3 Manual Mode

- ▶ Turning the [Manual] knob to [Close] direction, the door will be locking.

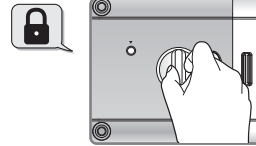

## 03 User's Guide

### 9 Force Lock Setting

#### ■ Outside Force Lock - The lock is Forced Lock Outside

##### SETTING

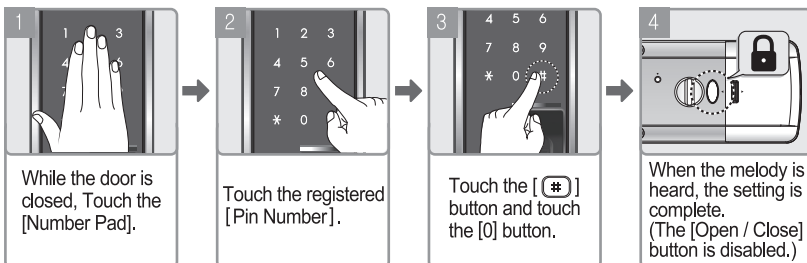

##### CANCEL

Open the door via Pin Number or Fingerprint. The [Force Lock] setting will be cancelled.

#### ■ Inside Force Lock - The lock is Forced-lock inside.

##### SETTING

- ① While the door is closed
- ② Press the [ Safety ] button for 3 seconds.  
When the melody is heard, the setting is complete.

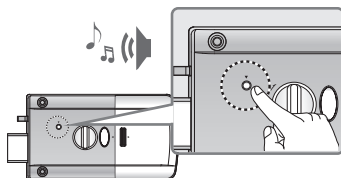

##### CANCEL

Open the door via [Manual] Knob, [Open / Close]  
The [Force Lock] setting will be cancelled.

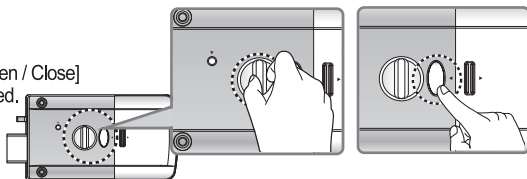

## 04 Convenient Features

### 1 Mute Mode Setting

Sets the audio and melody guide to mute mode.

#### SETTING

- ① Touch the [Number Pad], and Press [ \* ] button. (No status melody)



- ② How to use Pin Number : Enter [Pin Number], and Press [ \* ] button.  
The door will be opening. (Lamp will blink)



- ② How to use Fingerprint : Touch the Sensor, and slide the fingerprint on the [Fingerprint Scanner]



#### Note

This setting is 1 time only. The next operation will activate the sound again.

### 2 Volume Setting

This feature will adjust the sound volume by level per user preferences (Performed while door is closed)

#### USAGE

※ Volume can be set up to 7 levels.

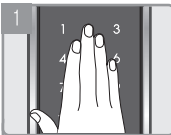

Touch the  
[Number Pad]  
on the Front body.



Enter the  
[Pin Number].



Press the  
[ \* ] button.

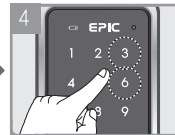

Then Press [3] or  
[6] button.



#### Note

Outbody      [3] Press to increase sound.  
                    [6] Press to decrease sound.

When the sound is in mute mode. Everytime a number is pressed  
on the number pad. The number pad will blink.

## 04 Convenient Feature

### 3 Automatic / Manual Lock Setting

Sets the door locking mode to Manual or Automatic Lock Mode

#### Setting Manual / Automatic Mode

Perform operation while door is open

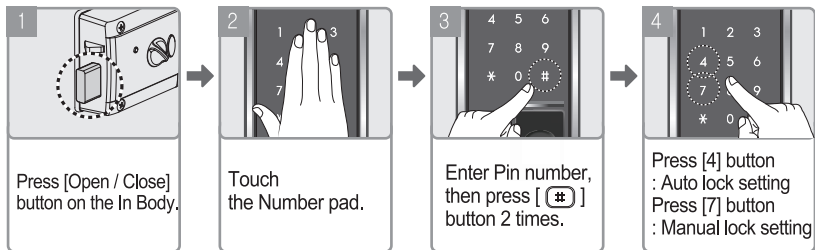

#### Note

Automatic mode is set in default. When you set the manual lock, The door will not automatically lock after closing the door. You need to press [Open/Close] button inside or Touch the number pad outside to close the door

## 04 Convenient Features

### 4 Multi-touch Feature

#### Note

This is a security feature that prevents the password from being exposed, by removing traces of fingerprint patterns on the number pad. The multi-touch feature is disabled in default.

- ① Touch the [Number Pad] on the Front body,

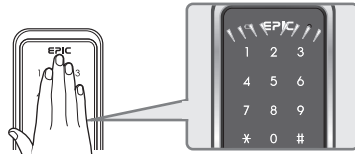

- ② Enter the Pin number.



- ③ Press the [ # ] button.



- ④ Press the [5] button on the number pad,  
A melody will be heard and Multi-touch feature setting is complete.



#### Note

To cancel the setting, just repeat steps ①, ②, ③, ④.

#### Caution

When multi-touch feature is enabled, after entering pin number  
Press the 3 digit number that is displayed on the screen  
Press [ \* ] button and the door will open  
When this feature is enabled, the Random number feature is cancelled

## 04 Convenient Feature

### 5 Dual-mode Security Feature Setting

The Pin number, Fingerprint should be registered first before setting this feature.

- ① Press [Register] button for 5 seconds  
The entire LED will light up After 3 seconds the alarm will stop  
And after 2 seconds it will be on again.
- ② Enter current user password.  
When you press [] button,  
The front panel LED will blink and light-up.

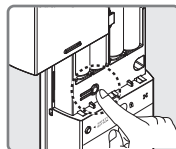

- ③ Press [ 1 ] button to Turn-Off Dual-Mode Security  
Press [ 3 ] button to Turn-On Dual-Mode Security.

During Dual-Mode Security Setting,  
when the confirmation sound is heard,  
everything will be turned-off



### HOW TO OPEN THE DOOR



PIN NUMBER

FINGERPRINT

#### Note

- ◆ While Dual-Mode Security Entry is on stand-by state, Other buttons cannot be entered.
- ◆ When in Security Mode Entry, please press a key within 10 seconds or it will turn off.  
When Setting Buzzer : Time Out Sound
- ◆ When the Dual-Mode Security is set After the user password has been registered  
2nd authentication is needed And the door will open.
- ◆ After entering the user password The numbers [1] [2] [3] [6] [9] [#] [0] [\*] [7] [4]  
will be displayed sequentially on the front LED When the (Tornado Shape) is displayed  
It is in the secondary authentication status.
- ◆ During 2nd authentication Use registered fingerprint and the door will open  
(When entering fingerprint, place fingerprint on fingerprint sensor)
- ◆ The guest pin number doesn't need 2nd authentication Just enter and the door will open
- ◆ Even if the guest pin number is identical with user password  
It doesn't need 2nd authentication, the door will just open (1-Time-Entry)
- ◆ During 2nd authentication, please enter pin number within 10 seconds or it will turn off.
- ◆ 2nd authentication is applied the same with  
(Successful Authentication, Failed Authentication, 1-minute Lock)

## 05 Alarm Features

### 1 Fire Alarm

If the inside temperature rises higher than normal, the heat sensor will activate an alarm and automatically unlocks the door.

When the inside temperature rises to ( $62^{\circ}\text{C} \pm 5^{\circ}\text{C}$ ), the lock will generate an alarm and automatically unlocks the door.

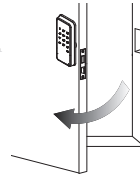

#### ⚠ Caution

Prolonged exposure to direct sunlight can activate the fire alarm and automatic unlock. Even in force lock status.

When the temperature goes back to normal. The door lock will go back to its normal state.

### 2 Anti-Hacking Alarm

If the lock senses abnormal operation inside or outside, it will generate an alarm.

When the door detects abnormal operation or forceful opening from the outside, the lock will generate a loud 80(db) alarm.



### 4 Cancelling Alarm

Removing battery, entering pin number or fingerprint on sensor cancels the alarm.

※ Fire alarm cannot be cancelled, unless the temperature goes back to normal.



Cancellation

## 05 Alarm Features

### 3 Anti-Prank & 1 Minute Lock

When the lock senses abnormal operation from outside, the lock will shut-off for 1 minute.

5 times repeated failed [Pin Number] and [Fingerprint] entry will activate a series of alarm and the lock will not function for 1 minute.



5 consecutive failed  
Pin number / Fingerprint entry??



### 4 Deadbolt Error Alarm

When the door is not closed properly or the deadbolt is jammed.  
A series of alarm will be activated 3 times.

#### Hook

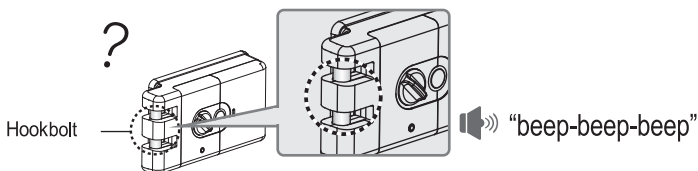

#### Deadbolt

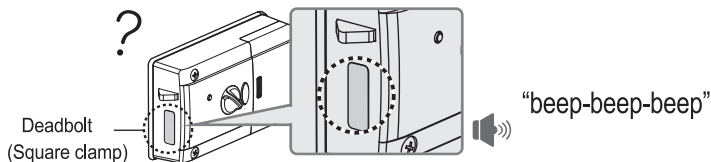

**Caution**

In case the alarm doesn't stop contact customer service and ask for assistance.  
Service cost may occur based on service location.

## 05 Alarm Features

### 5 Replace Battery Alarm

#### Replace Battery

During normal operation and a series of alarm is heard, it indicates the need for battery replacement. Please replace all battery with new ones at this time.

“Beep-beep-beep”







#### Caution

- Please replace all batteries all-at-once. Do not mix new and old batteries.
- Battery life may differ based on brand, manufacturing date, and installation environment. Do not mix batteries of different brand.
- Check batteries regularly for leakage.
- When the replace battery alarm is heard, replace the battery first before new registration.

#### Emergency Battery

When the battery is completely discharged

				
<p>9V battery is purchased separately.</p>	<p>Place on the 9V battery terminal located at the bottom of the front body.</p>	<p>Press the [ * ] button.</p>	<p>Enter the [ Pin Number ]</p>	<p>Press the [ * ] button again and the door will open.</p>

## 06 Troubleshooting

- When the product is not performing normally.  
Please check following conditions below and follow troubleshooting procedures.  
If the same problem occur please contact customer service center.

PROBLEM	TROUBLESHOOTING PROCEDURE	PAGE
NOT TURNING ON	<ol style="list-style-type: none"> <li>1. Please check battery for damage and check correct polarity placement.</li> <li>2. Make sure to replace old battery with new ones.</li> </ol>	PAGE 23
PIN NUMBER CANNOT BE CHANGED	<ol style="list-style-type: none"> <li>1. Press registration button until melody comes out.</li> <li>2. Refer to the manual for the correct pin number registration.</li> </ol>	PAGE 8
CANNOT OPEN THE DOOR WITH PIN NUMBER	<ol style="list-style-type: none"> <li>1. Check if the entered pin number is correct.</li> <li>2. When the pin number is not entered within 10 seconds on the number pad. The authentication will be cancelled. Press [  ] button and enter pin number again.</li> </ol>	PAGE 8 PAGE 13
CANNOT OPEN THE DOOR WITH PIN OR FINGERPRINT	<ol style="list-style-type: none"> <li>1. Try using 9V battery.</li> <li>2. The deadbolt can be defective. You must ask for assistance from service center.</li> </ol>	PAGE 22 PAGE 23
CANNOT REGISTER YOUR FINGERPRINTS	<ul style="list-style-type: none"> <li>- Matching fingerprint should be registered twice</li> <li>- Enter fingerprint within 20 seconds upon pressing [Registration] button.</li> <li>- After 100 fingerprints has been registered. The fingerprint module will not work. Delete all fingerprints first before registering new ones</li> <li>- Some people, like children can have difficulty in registering / authenticating fingerprint</li> </ul>	PAGE 9 PAGE 10
CANNOT OPEN THE DOOR WITH FINGERPRINTS	<ul style="list-style-type: none"> <li>- Check if the scanner or finger is not wet or has dust Clean first before using.</li> </ul>	PAGE 3
DURING OPERATION ALARM WON'T STOP	<ol style="list-style-type: none"> <li>1. It can be the replace battery alarm</li> <li>2. Please replace all battery at this time.</li> </ol>	PAGE 23
AUTOMATIC LOCK DO NOT WORK	<ol style="list-style-type: none"> <li>1. Set to automatic mode again.</li> <li>2. You can also replace the battery.</li> </ol>	PAGE 18 PAGE 23

A/S

For any technical assistance or inquiries please contact us.

## 07 Warranty & A/S

For consumer protection we follow certain policies as below installation should be done by skilled installer only  
Defects that occurred because of faulty installation may not be covered by warranty.

### ■ Free Service

The free service is applicable within 1 year upon purchase of items  
defects that occurred during this period is valid for free repair service.

TYPE OF DAMAGE		COVERAGE DETAILS	
		WARRANTY PERIOD	AFTER WARRANTY
Defects that occurred within 10 day after purchase		New replacement	
Defects that occurred within 1 month after purchase		New replacement	
Repairable	The same defect occur for 3 times	Free service	Service cost occur
	The same defect occur for 4 times	New replacement	Service cost occur
Non-Repairable	Needs replacement of parts Within warranty	New replacement	Depreciated cost
	Needs replacement of parts Within warranty	New replacement	Depreciated cost

### ■ With Service Fee

1. NOT DEFECTIVE	<ul style="list-style-type: none"><li>• When customer request for repair, but the item is not defective. Reading the user manual Should be advised carefully to consumer.</li><li>• The item is not defective, but there is problem with installation.</li><li>• The Pin number is lost and the lock was forced-fully opened</li></ul>
2. DEFECT CAUSED BY CONSUMER	<ul style="list-style-type: none"><li>• Damage caused by consumer negligence</li><li>• Damage caused by faulty installation by unskilled installer or repaired by end-user and not an engineer</li><li>• Damage caused by carelessness (Dropping, Knocking, etc..)</li></ul>
3. OTHER FACTORS THAT CAUSED THE DEFECT	<ul style="list-style-type: none"><li>• Damaged caused by natural disasters</li><li>• Consumable components reach its end-life</li><li>• For consumers that doesn't have the warranty card. the warranty coverage will be 15 months from the date of sale</li></ul>

## 08 Warranty certificate

PRODUCT NAME	EPIC POPscan
APPLIED MODEL	
SERIAL NUMBER	
DATE OF PURCHASE	
CUSTOMER NAME	
TELEPHONE NUMBER	
ADDRESS	
RESELLER BUSINESS NAME	
TELEPHONE NUMBER	
ADDRESS	
INSTALLER NAME	

※ To request after sales service this warranty certificate should be presented please keep this document.

1. The product quality certificate
2. The warranty period is calculated from the date of purchase, please obtain date of purchase.

※ This product is (class B) EMC equipment. And is intended for use in homes

※ For development purposes, the product can be modified,  
as well as the contents of this manual.  
Without prior notice.

## MEMO



Epic Systems Co., Ltd.

No. 406, Technology Development Center, 705, Haeam-ro,  
Sangnok-gu, Ansan-si, Gyeonggi-do, Rep. of Korea

■ A/S Hotline : +82 - 70 - 7124 - 6911 ■ [www.epic.co.kr](http://www.epic.co.kr)



**This product is non-mechanical key type**  
**In case of emergency, The door can be forced-fully open.**  
**For safety, usage of the manual lock lever should be familiarize.**